



TF50

GALLERY

TF50

STANDARD DUTY

Pinch batten must be used. Other cavity sizes available.

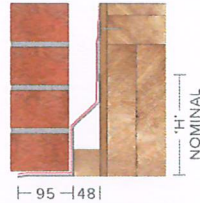

Length	750-1350	1500-1650	1800-2250	2400-3000	3150-3900
L (kN)	8	8	10	10	10
W (kg/m)	3.8	4.1	5	5.9	6.8
H (mm)	108	128	178	178	179

(L) Load SWL (W) Weight (H) Height

PRODUCT ATTRIBUTES

Brand	Birtley
Generic Ref	TF50
Product Range	Timber Frame Lintels
Product Sub-range	50-65mm Cavity
Product Type	Standard Duty Timber Frame Lintel - 100mm Outer Leaf
European Standard/ETA	BS EN845-2:2013+A1:2016
Test Standard	EN846-9:2000/2016
Notified Body	Lucideon Ltd (NB 1289)
Material	Mild Steel S275JR to BS EN10025-2:2004
Coating/Finish/Colour	65µm Hot Dip Galvanized to BS EN ISO 1461:2009
Thermal Performance	Contact us for information
Fire Rating	60 mins (with 2 coat plaster finish)
Installation requirement 1	Bed fully on bricklaying mortar
Installation requirement 2	Must be used with a cavity tray - External walls only
Installation requirement 3	Use lintel clips at <600mm intervals, not more than 225mm from each end
Installation requirement 4	Lintels over 1200mm must be propped until masonry is fully loaded and cured.

Installation requirement 5	150mm Minimum end Bearing
Sales Qty	1
Packaging weight	0
Features/Benefits 1	Supergalv coating offers superior life expectancy
Features/Benefits 2	Post-fabrication galvanizing leaves no surface with inferior paint protection
Features/Benefits 3	Structural grade steel to EN10025
Options 1	Alternative material options: Ultragalv coating (150µm), Stainless Steel 1.4301 (304)
Options 2	Outer Leaf Options: No rainwater drip (ND), Render mesh (MF)